

HOKE COUNTY

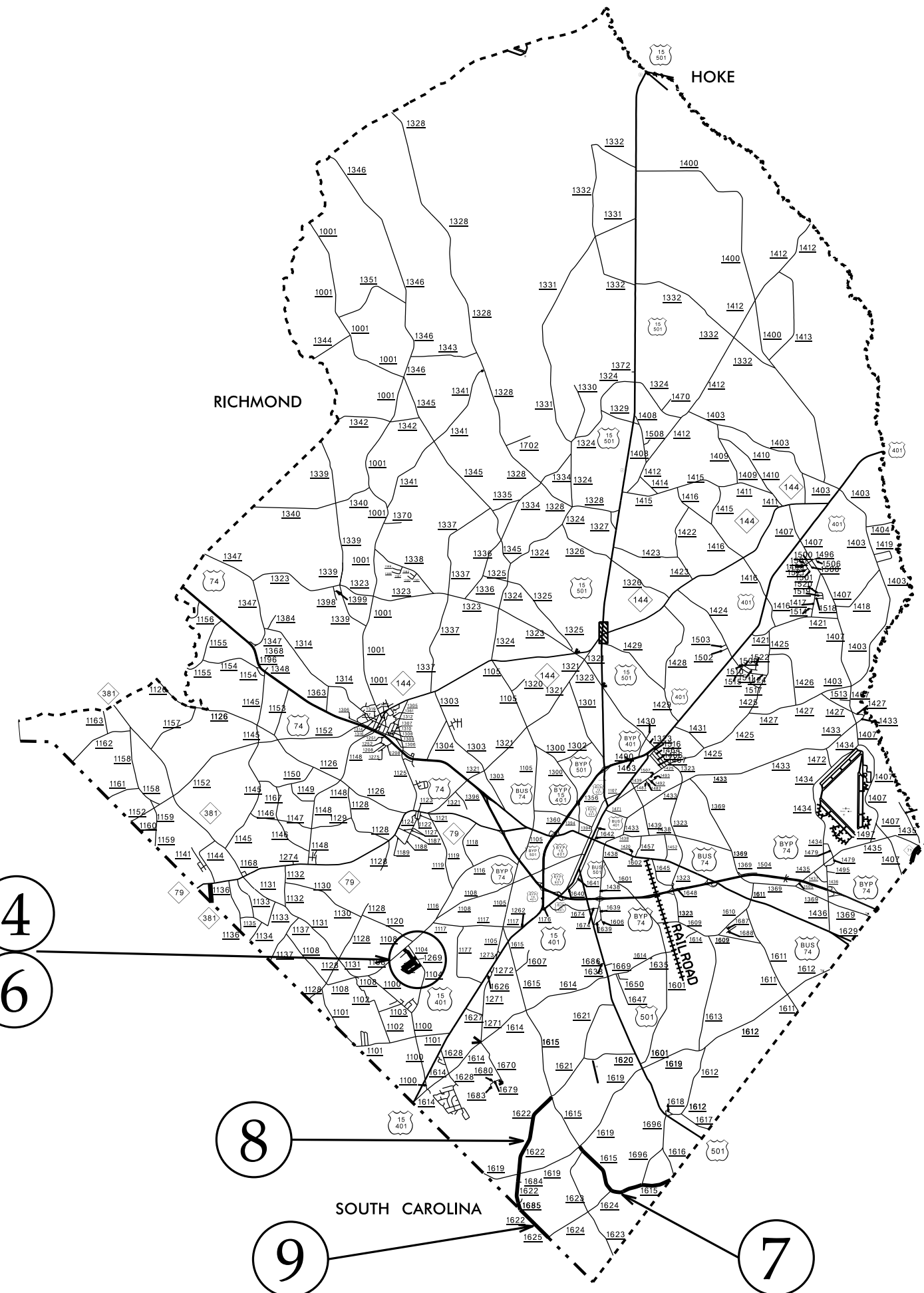

3 4
5 6

8

9

7

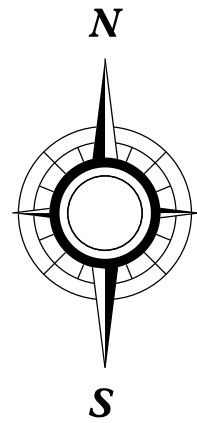

SCOTLAND COUNTY

Map 7

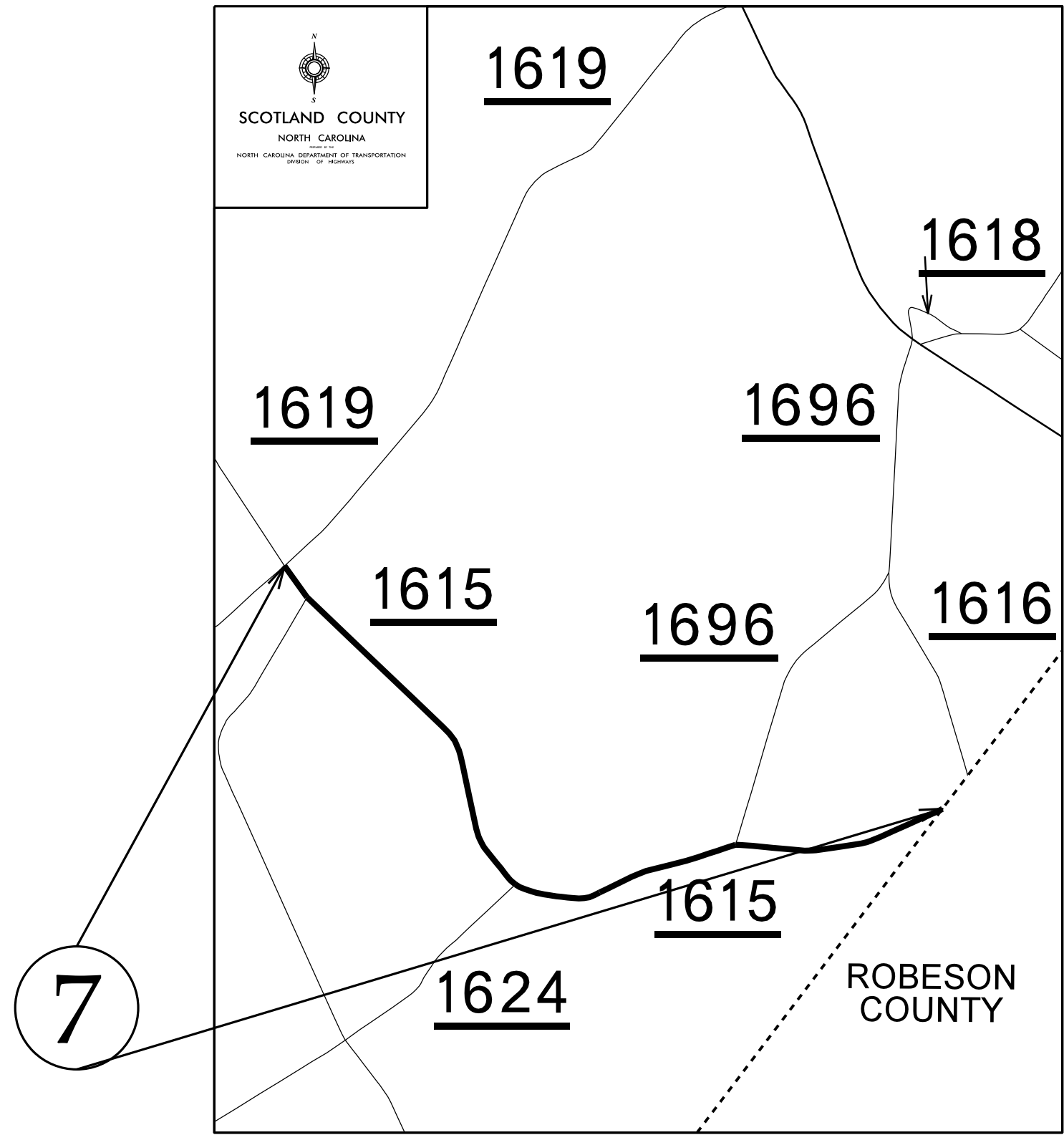

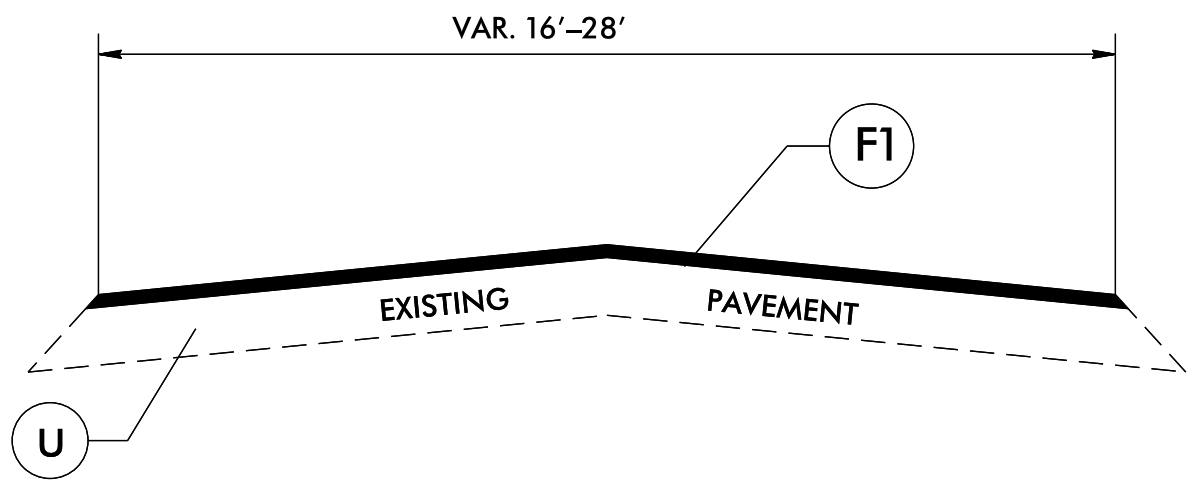

TYPICAL SECTION NO. 1

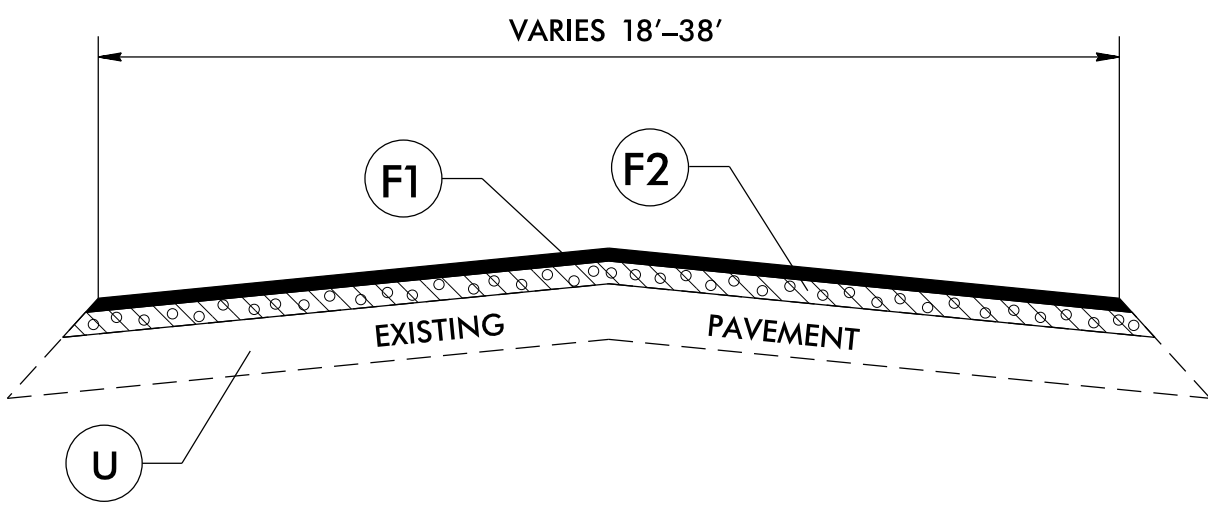

TYPICAL SECTION NO. 2

PAVEMENT SCHEDULE	
F1	PROP. ASPHALT SURFACE TREATMENT DOUBLE SEAL
F2	PROP. ASPHALT SURFACE TREATMENT FOG SEAL
U	EXISTING PAVEMENT

DETAILS OF PATCHING EXISTING PAVEMENT PRIOR TO AST

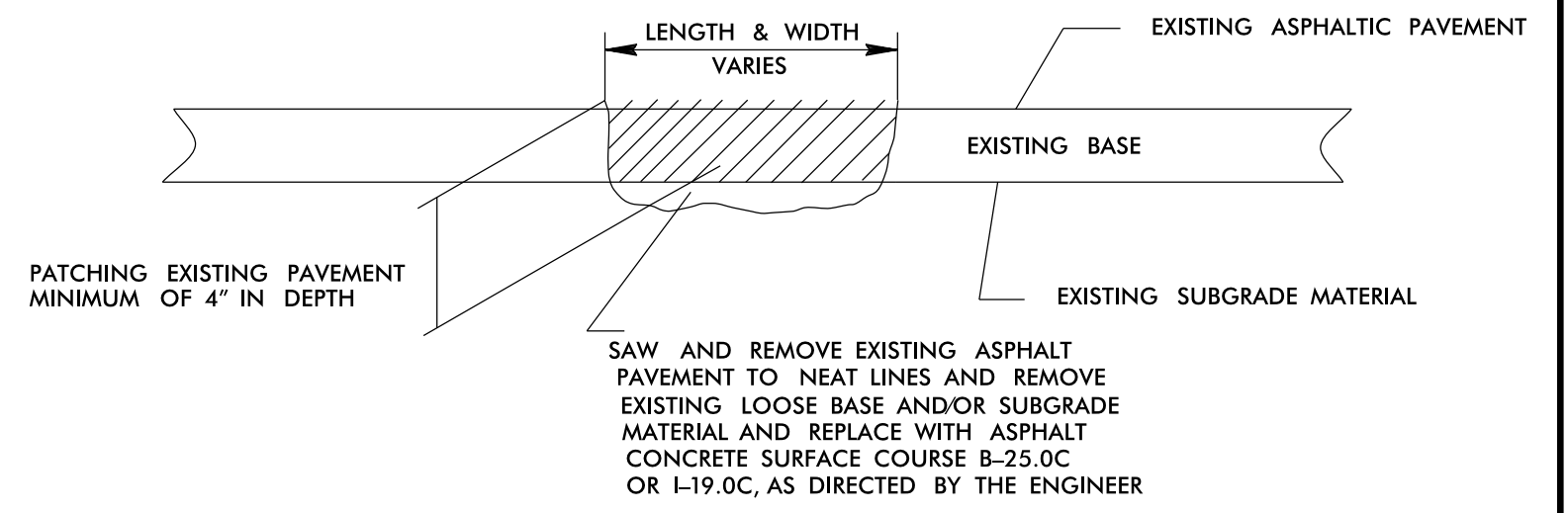

PROJECT NO. 2024CPT.08.05.20472, 2024CPT.08.05.20832	SHEET NO. 10	TOTAL NO.
--	------------------------	-----------

SUMMARY OF QUANTITIES

PROJECT NO	COUNTY	MAP NO	ROUTE	DESCRIPTION	TYP NO	LANES	LANE TYPE	FINAL SURFACE TESTING REQUIRED	WARM MIX ASPHALT REQUIRED	LENGTH	WIDTH	BEGIN MP	END MP	1575000000-E	1704000000-E	1803500000-E	1820000000-E	1838000000-E	1838500000-N	2143000000-E		
														ASPHALT BINDER FOR PLANT MIX	PATCHING EXISTING PAVEMENT	ASPHALT SURFACE TREATMENT, DOUBLE SEAL	ASPHALT SURFACE TREATMENT, FOG SEAL	EMULSION FOR ASPHALT SURFACE TREATMENT	VACUUM TRUCK	BLOTTING SAND		
														TONS	TONS	SY	SY	GAL	WK	TON		
														MI	FT							
2024CPT.08.05.20472	Hoke	1	SR-1120 / EDINBURGH RD	FROM US 401 (LAURINBURG RD) TO SR 1124 (WALTER GIBSON RD)	2	2	2WU	NO	YES	3.37	19	0	3.37			45,882.00	45,882.00	25,235				
TOTAL FOR MAP NO. 1										3.37						45,882.00	45,882.00	25,235				
2024CPT.08.05.20472	Hoke	2	SR-1124 / WALTER GIBSON RD	FROM SR 1116 (OLD MAXTON RD) SR 1105 (OLD WIRE RD)	1	2	2WU	NO	NO	3.66	18	3.6	7.26			40,867.00		22,477				
TOTAL FOR MAP NO. 2										3.66						40,867.00		22,477				
TOTAL FOR PROJ NO. 2024CPT.08.05.20472										7.03						86,749.00	45,882.00	47,712	4.00	10		
2024CPT.08.05.20832	Scotland	3	SR-1269 / LYTCH RD	FROM SR 1108 (X WAY RD) TO SR 1263 (QUAIL RIDGE DR)	2	2	2WU	NO	NO	0.5	20	0	0.5			7,720.00	7,720.00	4,246				
TOTAL FOR MAP NO. 3										0.5						7,720.00	7,720.00	4,246				
2024CPT.08.05.20832	Scotland	4	SR-1263 / QUAIL RIDGE DR	FROM SR 1104 (BOSTIC RD) TO END STATE MAINT.	2	2	2WU	NO	NO	0.51	20	0	0.51			8,124.00	8,124.00	4,468				
TOTAL FOR MAP NO. 4										0.51						8,124.00	8,124.00	4,468				
2024CPT.08.05.20832	Scotland	5	SR-1270 / DOVE ST	FROM SR 1263 (QUAIL RIDGE DR) TO SR 1269 (LYTCH RD)	2	2	2WU	NO	NO	0.29	21	0	0.29			4,107.00	4,107.00	2,259				
TOTAL FOR MAP NO. 5										0.29						4,107.00	4,107.00	2,259				
2024CPT.08.05.20832	Scotland	6	SR-1282 / PARTRIDGE DR	FROM SR 1263 (QUAIL RIDGE DR) TO SR 1269 (LYTCH RD)	2	2	2WU	NO	NO	0.4	18	0	0.4			4,084.00	4,084.00	2,246				
TOTAL FOR MAP NO. 6										0.4						4,084.00	4,084.00	2,246				
2024CPT.08.05.20832	Scotland	7	SR-1615 / HASTY RD	FROM ROBESON CO. LINE TO SR 1619 (PEA BRIDGE RD)	1	2	2WU	NO	YES	2.62	18	0	2.62	3	71	30,024.00		16,513				
TOTAL FOR MAP NO. 7										2.62				3	71	30,024.00		16,513				
2024CPT.08.05.20832	Scotland	8	SR-1622 / CRESTLINE RD	FROM SR 1625 (STATE LINE ROAD) TO SR 1615 (HASTY RD)	1	2	2WU	NO	YES	2.75	22	0	2.75	4	90	38,304.00		21,067				
TOTAL FOR MAP NO. 8										2.75				4	90	38,304.00		21,067				
2024CPT.08.05.20832	Scotland	9	SR-1625 / STATE LINE RD	FROM SR 1624 (GRAHAM RD) TO SR 1622 (CRESTLINE RD)	1	2	2WU	NO	YES	0.88	22	0	0.88	5	99	11,862.00		6,524				
TOTAL FOR MAP NO. 9										0.88				5	99	11,862.00		6,524				
TOTAL FOR PROJ NO. 2024CPT.08.05.20832										7.95				12	260	104,225.00	24,035.00	57,323	5.00	10		
GRAND TOTAL														14.98		12	260	190,974.00	69,917.00	105,035	9.00	20

PROJECT NO.	SHEET NO.	TOTAL NO.
2024CPT.08.05.20472, 2024CPT.08.05.20832	11	

THERMOPLASTIC AND PAINT QUANTITIES

PROJECT NO	COUNTY	MAP NO	ROUTE	DESCRIPTION	TYP NO	LANES	LANE TYPE	LENGTH		BEGIN MP	END MP	4413000000-E	4457000000-N	4810000000-E		4830000000-E	4835000000-E	4840000000-N		
								MI	FT			WORK ZONE ADVANCE/GENERAL WARNING SIGNING	TEMPORARY TRAFFIC CONTROL	4" WHITE PAINT	4" YELLOW PAINT	16" WHITE PAINT	24" WHITE PAINT	PAINT MSG RXR	PAINT MSG AHEAD	PAINT MSG STOP
												SF	LS	LF	LF	LF	LF	EA	EA	EA
2024CPT.08.05.20472	Hoke	1	SR-1120 / EDINBURGH RD	FROM US 401 (LAURINBURG RD) TO SR 1124 (WALTER GIBSON RD)	2	2	2WU	3.37	19	0	3.37	377	*	71,344	33,558	186	130	4		
TOTAL FOR MAP NO. 1							3.37				377	71,344		33,558	186	130	4			
2024CPT.08.05.20472	Hoke	2	SR-1124 / WALTER GIBSON RD	FROM SR 1116 (OLD MAXTON RD) SR 1105 (OLD WIRE RD)	1	2	2WU	3.66	18	3.6	7.26	410		77,508	46,090				5	4
TOTAL FOR MAP NO. 2							3.66				410	77,508		46,090				5	4	
TOTAL FOR PROJ NO. 2024CPT.08.05.20472							7.03					787	1.0000	148,852	79,648	186	130	4.000	5	4
														228,500		13.000				
2024CPT.08.05.20832	Scotland	3	SR-1269 / LYTCH RD	FROM SR 1108 (X WAY RD) TO SR 1263 (QUAIL RIDGE DR)	2	2	2WU	0.5	20	0	0.5	56	*							
TOTAL FOR MAP NO. 3							0.5				56									
2024CPT.08.05.20832	Scotland	4	SR-1263 / QUAIL RIDGE DR	FROM SR 1104 (BOSTIC RD) TO END STATE MAINT.	2	2	2WU	0.51	20	0	0.51	57								
TOTAL FOR MAP NO. 4							0.51				57									
2024CPT.08.05.20832	Scotland	5	SR-1270 / DOVE ST	FROM SR 1263 (QUAIL RIDGE DR) TO SR 1269 (LYTCH RD)	2	2	2WU	0.29	21	0	0.29	32								
TOTAL FOR MAP NO. 5							0.29				32									
2024CPT.08.05.20832	Scotland	6	SR-1282 / PARTRIDGE DR	FROM SR 1263 (QUAIL RIDGE DR) TO SR 1269 (LYTCH RD)	2	2	2WU	0.4	18	0	0.4	45								
TOTAL FOR MAP NO. 6							0.4				45									
2024CPT.08.05.20832	Scotland	7	SR-1615 / HASTY RD	FROM ROBESON CO. LINE TO SR 1619 (PEA BRIDGE RD)	1	2	2WU	2.62	18	0	2.62	293			52,536	40,756				
TOTAL FOR MAP NO. 7							2.62				293		52,536	40,756						
2024CPT.08.05.20832	Scotland	8	SR-1622 / CRESTLINE RD	FROM SR 1625 (STATE LINE ROAD) TO SR 1615 (HASTY RD)	1	2	2WU	2.75	22	0	2.75	308		56,514	38,400					
TOTAL FOR MAP NO. 8							2.75				308		56,514	38,400						
2024CPT.08.05.20832	Scotland	9	SR-1625 / STATE LINE RD	FROM SR 1624 (GRAHAM RD) TO SR 1622 (CRESTLINE RD)	1	2	2WU	0.88	22	0	0.88	99		18,960	7,210					
TOTAL FOR MAP NO. 9							0.88				99		18,960	7,210						
TOTAL FOR PROJ NO. 2024CPT.08.05.20832							7.95					890	1.000	128,010	86,366					
														214,376						
GRAND TOTAL								14.98				1,677	1.000	276,862	166,014	186	130	4.000	5	4
														442,876		13				

SIGNING FOR ASPHALT SURFACE TREATMENT

LEGEND

- ▷ PORTABLE SIGN
- └ STATIONARY SIGN
- ← DIRECTION OF TRAFFIC FLOW

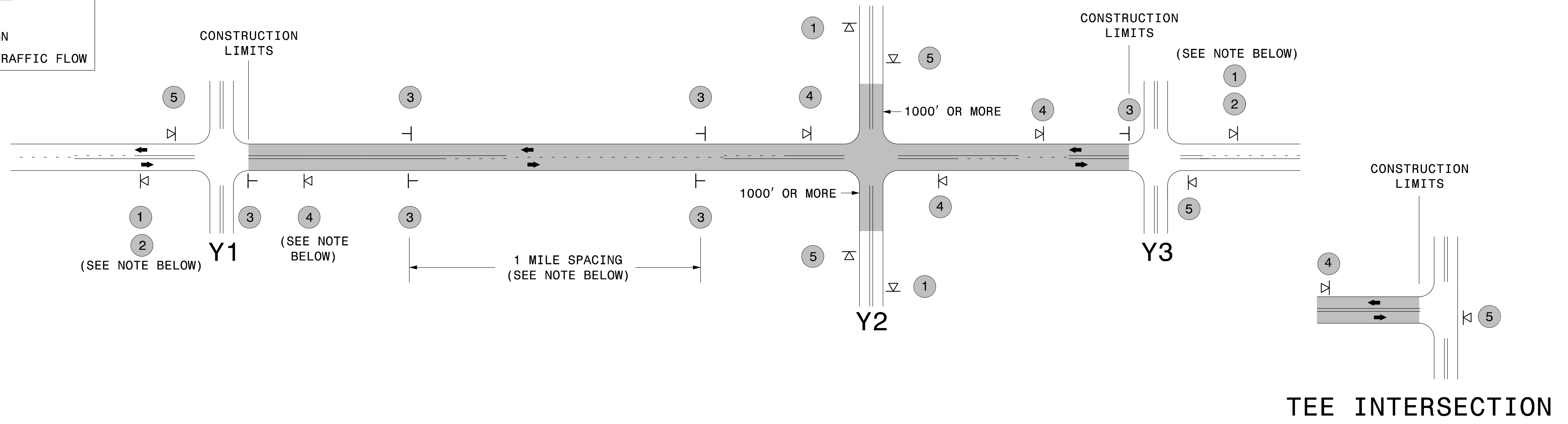

MAINLINE (-L-) SIGNING

-Y- LINE SIGNING

SIGNING NOTES AND PLACEMENT PER DIRECTION		<ul style="list-style-type: none"> - PLACE 1000' PRIOR TO BEGINNING OF CONSTRUCTION LIMITS. ONLY USED ON -Y- LINES IF RESURFACING LIMITS EXTEND 1000' ALONG -Y- LINE. - SIGN #2 ONLY USED WHEN RESURFACING LIMITS ARE 2 OR MORE MILES IN LENGTH. ROUND UP TO THE NEAREST WHOLE NUMBER. DO NOT USE FRACTIONAL OR DECIMAL NUMBERS. 	<p>STATIONARY SIGNING NOT REQUIRED FOR THE FOLLOWING -Y- LINE CONDITIONS:</p> <ol style="list-style-type: none"> 1) LESS THAN 1000' OF RESURFACING ALONG -Y- LINE 2) SUBDIVISION ROADS 3) DEAD END ROADS <p>WHEN PAVING/CONSTRUCTION ACTIVITIES PROCEED ACROSS AN UNSIGNED -Y- LINE, PORTABLE ADVANCE WARNING SIGNS SHALL BE USED ALONG THE -Y- LINE AS SHOWN BELOW. REMOVE UPON COMPLETION OF WORK.</p> <div style="display: flex; justify-content: space-around;"> <div style="text-align: center;"> <p>PLACED 500' IN ADVANCE OF FLAGGER.</p> </div> <div style="text-align: center;"> <p>PLACED 250' IN ADVANCE OF FLAGGER.</p> </div> </div>
		<ul style="list-style-type: none"> - ALTERNATE THE FOLLOWING TWO SIGNS: - STARTING WITH "LOOSE GRAVEL" (W8-7) FOLLOWED BY "UNMARKED PAVEMENT". - PLACE INITIALLY AT THE CONSTRUCTION LIMITS AND SPACED 1 MILE APART THEREAFTER. - AT TEE INTERSECTIONS INSTALL INITIALLY 0.5 MILE FROM INTERSECTION AND SPACE 1 MILE APART THEREAFTER. 	
		<ul style="list-style-type: none"> - THESE ARE FOR -Y- LINES THAT ARE "THROUGH" ROADWAYS. DEAD END AND SUBDIVISION ROADS ARE NOT "THROUGH" ROADWAYS. - INSTALL 500' +/- FROM EACH -Y- LINE APPROACH AS SHOWN ABOVE. - FOR MULTIPLE -Y- LINES THAT ARE SEPARATED BY 0.25 MILES OR LESS, TREAT AS A SINGLE UNIT AND INSTALL WITHIN 500' OF EACH APPROACH. - A MAXIMUM OF 2 SIGN SETS PER MILE. DO NOT INSTALL WHEN -Y- LINES ARE WITHIN 0.5 MILES FROM "END ROAD WORK" SIGN. 	
		<ul style="list-style-type: none"> - PLACE 500' FOLLOWING THE END OF CONSTRUCTION LIMITS OR AS SHOWN WHEN WORK ENDS AT A 3-WAY TEE INTERSECTION. 	
	<p>THE ABOVE SIGNS ARE ALL THAT ARE REQUIRED FOR A CONTRACTOR TO BEGIN A RESURFACING CONTRACT. ANY ADDITIONAL SIGNS REQUESTED BY NCDOT DIVISIONS SHALL BE INSTALLED WITHIN 7 BUSINESS DAYS OF THE START OF CONTRACT WORK.</p>		

MAPS LESS THAN 2 MILES

FOR AST RESURFACING MAPS WITH CONSTRUCTION LIMITS LESS THAN 2 MILES IN LENGTH, USE A STATIONARY "LOOSE GRAVEL" SIGN AT THE BEGINNING CONSTRUCTION LIMIT FOLLOWED BY AN "UNMARKED PAVEMENT" SIGN MIDWAY THROUGH AND AN "END ROAD WORK" SIGN AT THE END CONSTRUCTION LIMIT.

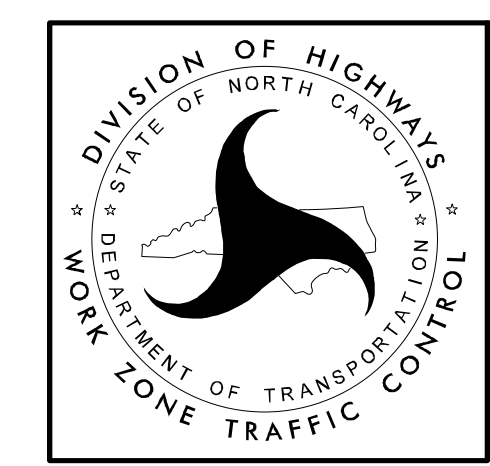

ADVANCE WARNING SIGNS FOR 2-LANE ROADWAY ASPHALT SURFACE TREATMENT

5/12/2017 S:\TUXWZTC\Resurfacing\2L2W & AST Resurfacing Details\Resurfacing_AdvWarn_2Ln - AST.dgn User:kdais